

4030(35)
4030(44)

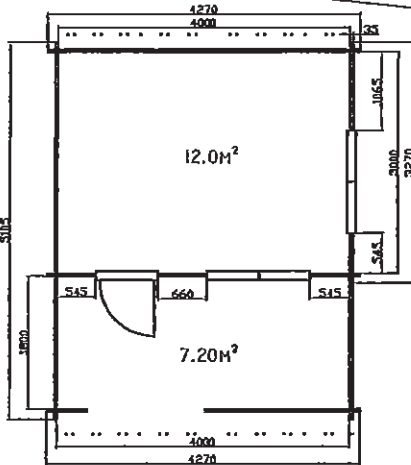
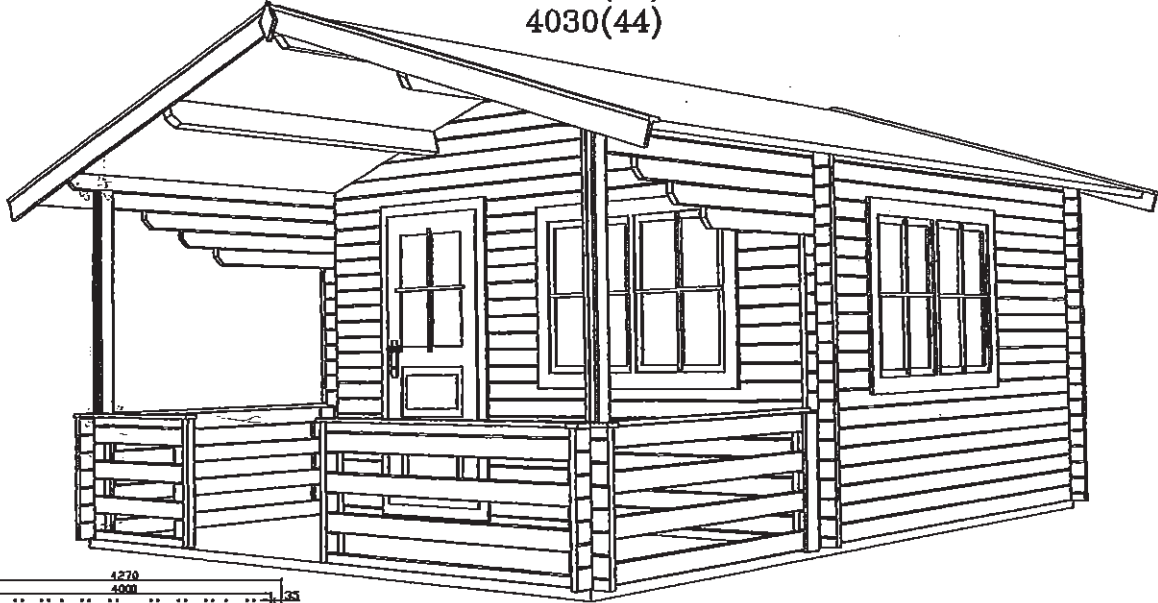

4×3m (35mm、44mm)
軒の出2.1m /パランダ1.8m
外部ドアガラス付き1
ダブル窓ガラス付き2 (内開き)

床板22mm /屋根板19mm
棟木・母屋140×60mm
土台100×40mm・50×40mm
壁の高さ2.1m /屋根最高高さ2.77m

3530(44)

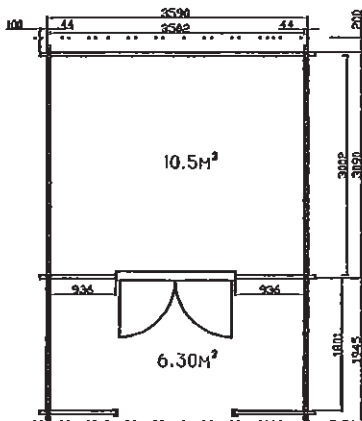
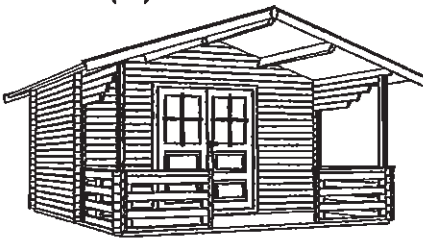

3.5×3m /軒の出1.95m /パランダ1.8m
高さ2.7m

4030(35)
4030(44)

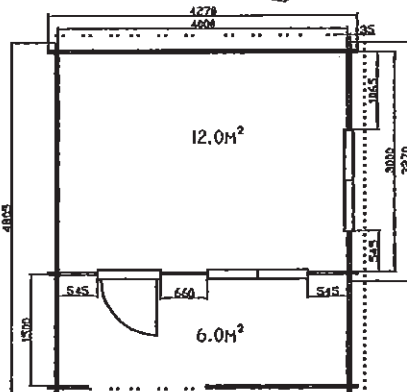
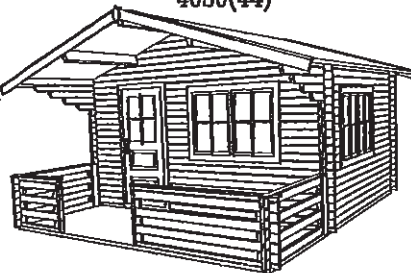

4×3m /軒の出1.5m /パランダ1.5m

4030(35)
4030(44)

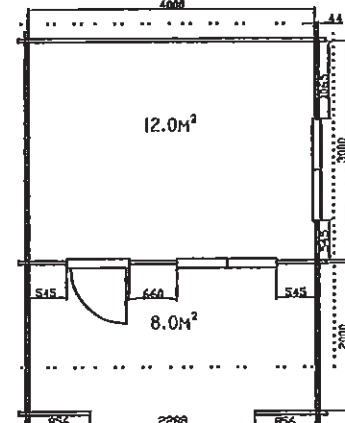

4×3m /軒の出1.4m /パランダ2m