

3030(35)

3030(44)

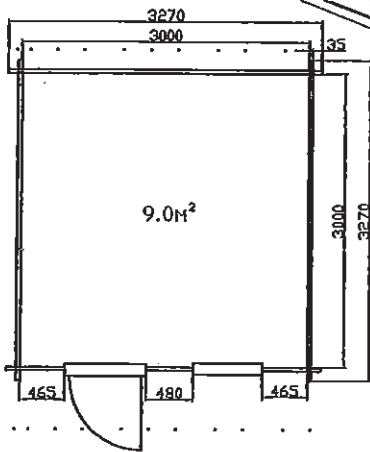
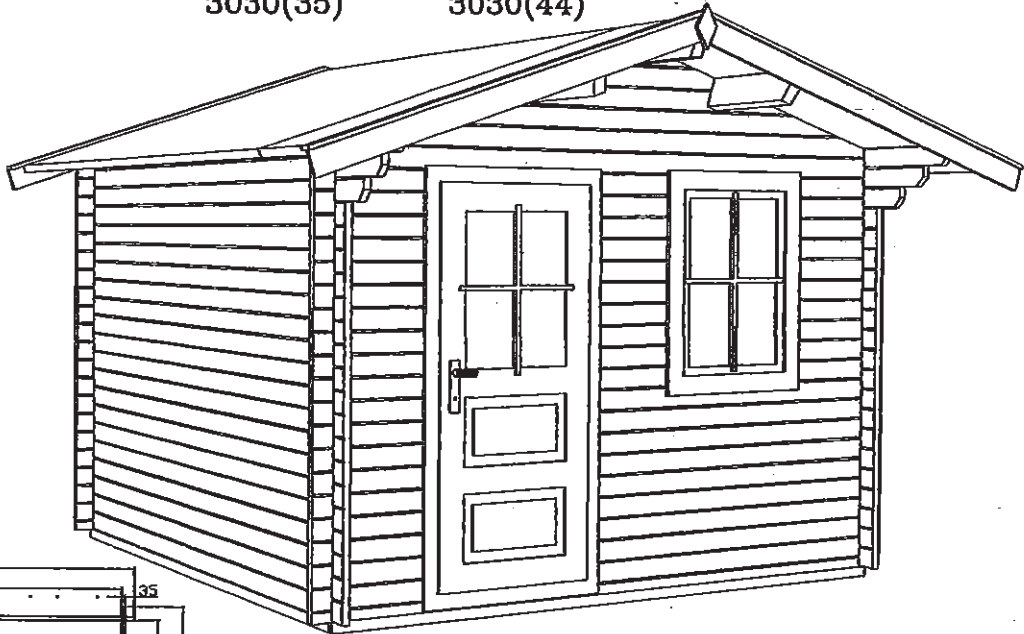

3×3m (35mm、44mm)
 軒の出0.6m
 外部ドアガラス付き1 / 窓1 (内開き)
 床板22mm / 屋根板19mm
 棟木・母屋140×44mm
 土台100×40mm・50×40mm

壁の高さ2.1m
 屋根最高高さ2.61m

3030(35)
 3030(44)

3030(35)
 3030(44)

3040(35)
 3040(44)

3040(35)
 3040(44)

3040(44)

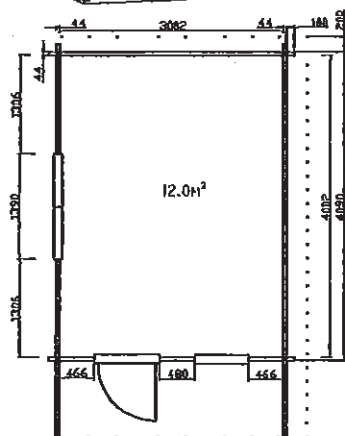
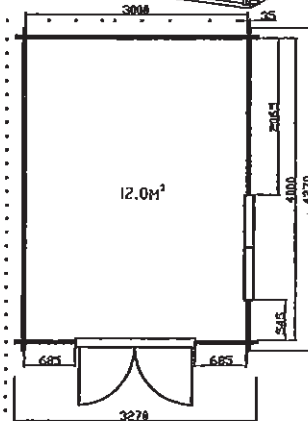
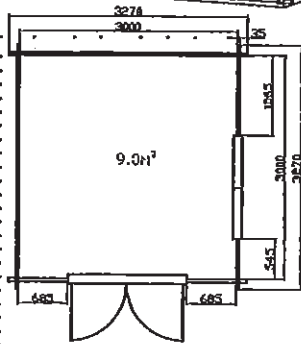
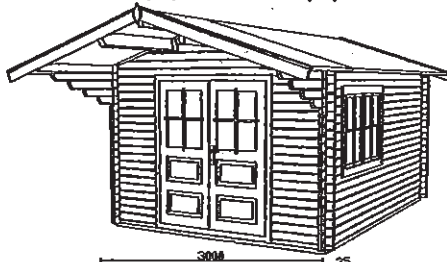
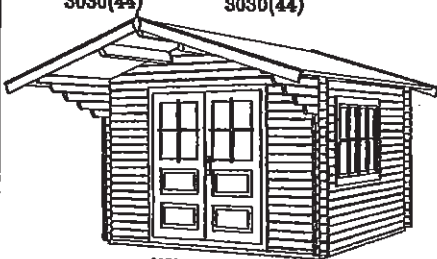

3×3m / 軒の出1m (1.5m)
 ダブルドア
 壁の高さ2.1m / 屋根最高高さ2.61m

3×4m / 軒の出1m (1.5m)
 ダブルドア

3×4m / 軒の出1m
 シングルドア